

PRO-TEC KEY SAFE

Heavy Duty Push Button Key Storage

Product Code: HA00825

IMPORTANT!

Please read the following instructions carefully before installing your key safe. Always wear goggles or other suitable eye protection before starting to drill.

CONTENTS

1 x Key Safe	1 x Combination Protector Card with instructions
1 x TPU cover to protect and disguise your key safe	1 x Combination Setting Key
4 x Thunderbolts for securely fixing your key safe	

YOUR KEY SAFE

On the front of the key safe there are 12 buttons, numbers 1-0, plus letters A-B. There is also an 'Open' turn dial and a red 'Clear' catch. **The key safe is shipped from the factory without a preset combination.** This means that the 'Open' turn dial will open the key safe without any number buttons being pressed. **NOTE:** The key safe will not open if any of the numbers have been pressed.

If a button is pressed accidentally or incorrectly, slide the red Clear catch down. This clears the memory and resets all the number buttons.

BEFORE INSTALLING THE KEY SAFE

Select your own combination for the key safe.

As with all mechanical push button key safes, each number in a combination can only be used once.

It is recommended that you do not use a number combination that can be easily guessed. Avoid numbers linked to your telephone number or birthday. Do not use a bank card PIN number as this may breach your financial security should someone determine the combination to your key safe. Use a unique number that only you will know between four and six numbers inclusive.

Record it on the Combination Protector Card included; this should be safely stored so that in the unlikely event that you forget your combination it can be located and used to access your keys.

WARNING:

Please note that if you forget your combination gaining access to your key safe is not covered by your warranty. There are no master codes so the ONLY way to open the key safe is by using suitable tools and brute force.

Under no circumstances should you remove the screws on the inside cover of the lid. Your warranty will be void if tampered with.

SETTING YOUR COMBINATION

Step 1:

To set the combination for the first time, slide the Clear catch down to clear the memory and reset the number buttons. Rotate the Open dial button 90° clockwise and pull open the lid. The top of the key safe is conveniently hinged, take care so that the key safe door doesn't close on your fingers. Whilst open, rotate the turn dial 90° anti-clockwise back to its original position.

Step 2:

There are 12 metal dials, numbered 1-0 plus A-B, with red arrow indicators on the inner door. There is no preset combination so all the red arrows should be facing towards the word RESET.

NOTE: these numbers correspond to the numbered buttons on the front of the lid.

Step 3:

Using the Combination Setting Key provided, set each digit of your combination. To do this, simply place the Combination Setting Key into the metal dial, apply light pressure and rotate 180°.

The red arrow should now be facing towards the word SET. Repeat for each number in your combination. Take care to line up each red arrow in the correct direction - **90° turn will not work.**

DO NOT CLOSE THE KEY SAFE DOOR UNTIL YOU HAVE TESTED THE COMBINATION!

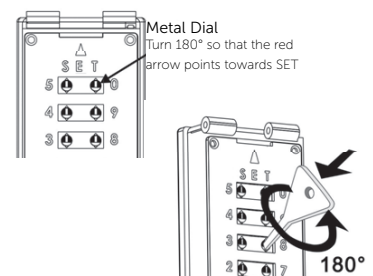

SCAN TO WATCH THE EASY INSTALLATION VIDEO!

TESTING YOUR COMBINATION

IMPORTANT:

ONCE YOU HAVE SET YOUR COMBINATION THE KEY SAFE SHOULD BE TESTED THOROUGHLY BEFORE CLOSING THE LID.

Once the lid is closed you will **only** be able to open the key safe using the combination you have set.

- Keeping the Key Safe OPEN, enter the numbers in your combination using the large number buttons on the front of the lid.
- Rotate the Open dial 90° clockwise.
- If the combination has been set correctly the Open dial will rotate smoothly and fully move the door's lock bolt down into the door.
- If the combination has been set incorrectly OR if the combination has been incorrectly entered the Open dial will not move and the lock bolt will not disengage. In this instance the combination settings and the combination entered should be checked and adjusted.
- If successful, rotate the dial back 90° anti-clockwise to reset the combination and try again.
- ONLY when your combination checking steps above have been successful 3 times should you close and lock the Key Safe.
- To do this, with your code entered and dial rotated 90° clockwise, shut the door fully and rotate the dial back 90° anti-clockwise.
- You should hear the click of the lock bolt re-engaging and your safe will stay shut until the code is entered again.

CHANGING YOUR COMBINATION

It is advised that you change the combination regularly. To reset the key safe:

- Open your Key Safe using your current combination. Make a note of the new combination you wish to use.
- Using the Combination Setting Key, apply light pressure and turn all the metal dials (180°) of your previous combination so that the red arrows all face towards the word RESET.
- The Key Safe no longer has a combination set. Now follow the instructions for SETTING YOUR COMBINATION.

INSTALLATION

Before you start you will need the following items to install your key safe:

- 4 x thunderbolts (5mm x 50mm) - supplied
- A power drill and extension lead (or heavy duty battery operated power drill)
- 5mm masonry drill bit
- Goggles or other suitable eye protection
- Marker / Pencil
- Tape Measure
- Roll of tape (electrical, masking or similar)
- A ratchet, extension and 8mm socket or a 8mm socket attachment for your power drill

Positioning your key safe

Your key safe should be carefully positioned so it is hidden from view. Typical locations might include: behind dustbins, plants, plant pots, in dustbin bays, behind drain pipes, on the side or rear of the property or any other location that is out of sight.

Fixing your key safe

Select a flat area of wall in an area where you can drill into brick. The bolts must be fixed into a masonry (brick or concrete) substrate and not into mortar joints, otherwise the installed safe will not meet the independent accreditation levels and may be easily levered off the wall. Ideally position your key safe across 2 or more bricks for maximum security.

Marking the wall

Using the base of the TPU cover as a template, mark 4 x hole positions onto the wall with a marker or pencil.

Drilling the brick

The holes that secure the thunderbolts must be drilled to at least 50mm. **It is essential that the holes are the correct depth - if not it will prove very difficult to fit the key safe properly.** Using the tape measure determine a distance of 50mm from the tip of the drill bit and wrap some tape around the bit to act as a marker. This should help you to drill to the correct depth and avoid drilling the holes unnecessarily deep. Drill the four holes to the correct depth using the power drill.

Inserting the thunderbolts & fitting your key safe

Position your key safe and TPU base over the 4 holes and insert the thunderbolts through the holes and hand tighten. Using your 8mm socket / ratchet / power drill carefully tighten the bolts. The bolts will "self tap" into the holes making the key safe very secure. Do not over tighten as this may cause the key safe to distort in shape or the thunderbolts may bind into the metal of the key safe.

IMPORTANT:

If the wall is not flat or if the thunderbolts are over tightened the key safe may distort. This will mean it may not close or open properly. This is not a fault of the key safe and is not covered by warranty. In some cases the key safe may be rendered unusable. Care should be taken in choosing a suitable even wall location and ensuring the fittings are not over tightened.

WARRANTY:

As a testament to our investment in quality we are delighted to offer a 7 year manufacturer's warranty on this product. To raise a claim contact us via the below website and ensure you have proof of purchase available. Terms and conditions apply, see our website for details.